



Sorocard

O MELHOR TORQUE DE PONTA A PONTA



CATÁLOGO
LINHA LEVE



CERTIFICADO

Sistema de Gestão para
NBR ISO 9001: 2015

A BRTÜV certifica que a empresa

Sorocard Indústria e Comércio Ltda.

Rua Felipe Moysés Betti Filho, 300 – Ipanema do Meio
18052-592 – Sorocaba – SP – Brasil

Implantou e utiliza um sistema de gestão de acordo com a norma acima, para o seguinte escopo

Industrialização e Comercialização de Componentes para Eixo Cardan e Prestação de serviços de usinagem.

Número do Registro do Certificado **TNBR-25522**

Válido a partir de 06/11/2019

Válido até 05/11/2022

Certificação Inicial 2019



Reginaldo Maia
Diretor Presidente

Barueri, 06/11/2019

A validade deste certificado está sujeita ao atendimento satisfatório e contínuo pela empresa das condições estabelecidas no contrato de certificação. Este certificado permite o registro na relação de empresas certificadas do Sistema Brasileiro de Avaliação da Conformidade.

BRTÜV Avaliações de Qualidade Ltda. Al. Madeira, 222 – 3º andar 06454-010 – Barueri – SP – Brasil www.brtuv.com.br



Cruzeta 5-153X

SF-13



Referência: 2-2-479
Original: -
Ford: F350 /
GM : AC10 - AC14 4 CIL. -
C15A - CD14

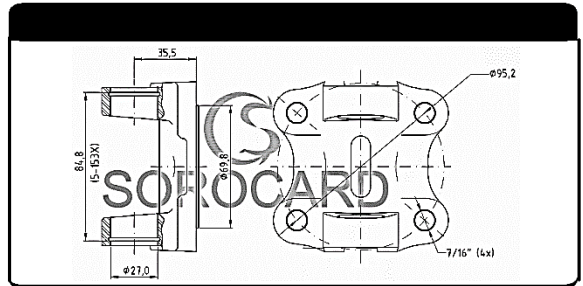

SF-27



Referência: -
Original: -
Ford: RANGER 4x4 (1998
Até 2012) - Cardan da
Tração (ADAPTAÇÃO DA
HOMOCINÉTICA)

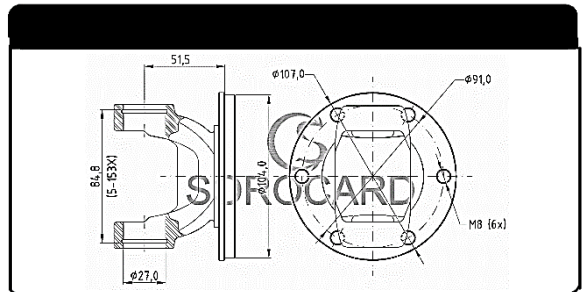

SF-31



Referência: -
Original: -
Ford: F350 PICK UP

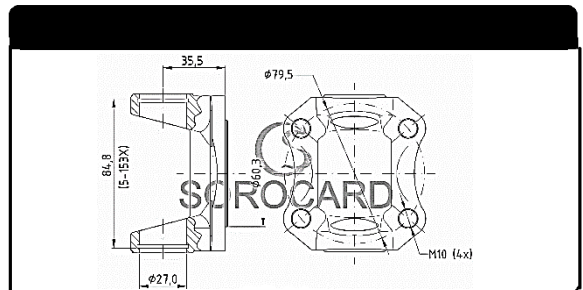

SF-45



Referência: 2-2-1679
Original: -
Toyota: HILUX PICK UP

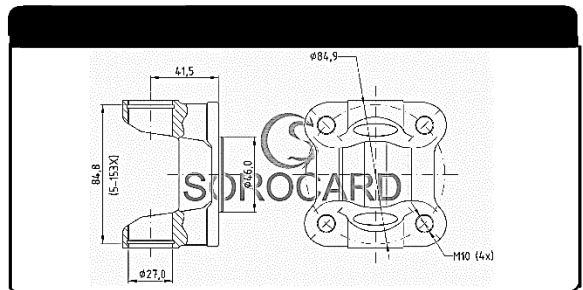

SF-47



Referência: 5001903
Original: -
Toyota: HILUX PICK UP

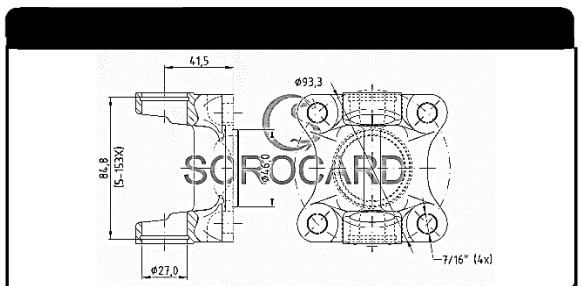

CRUZETA 5-153X

Cruzeta 5-153X

SF-51



Referência: 2-2-1459
Original: -
Iveco: IVECO DAILY 35.10
 CHASSI CABINE / FURGÃO

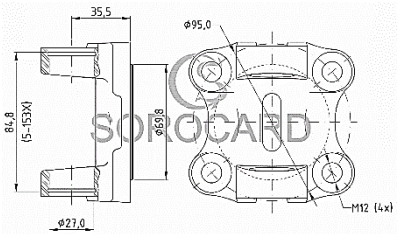

SF-63



Referência: -
Original: -
Ford: RANGER 2.5 DIESEL
 4X2 / 4X4 - SAÍDA CÂMBIO E
 DIFERENCIAL (ADAPTAÇÃO
 DA HOMOCINÉTICA)

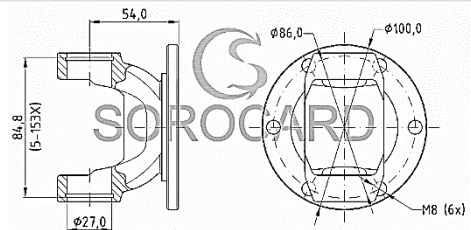

SF-68



Referência: -
Original: -
Ford: Ranger 2.8 4x2 / 4x4
 (Diferencial) - CARDAN DE
 ALUMÍNIO

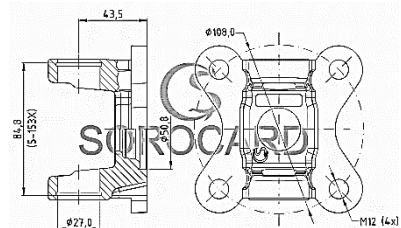

SF-69



Referência: -
Original: -
Ford: Ranger 2.8 4x2 / 4x4
 (Câmbio) - CARDAN DE
 ALUMÍNIO

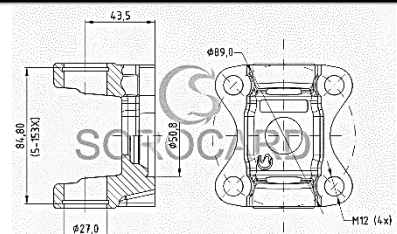

SF-70



Referência: -
Original: -
Kia: Kia Bongo (Adaptação da
 Cruzeta)

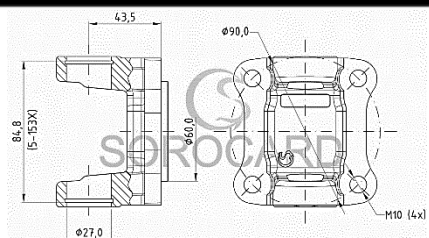

Cruzeta 5-153X

SF-71



Referência: -
Original: -
Mitsubishi: L200 Triton
 (Tração Dianteira – Adaptação da Cruzeta)

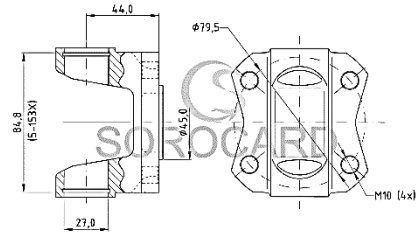

SF-73



Referência: 2-2-1979
Original: -
Nissan: FRONTIER
 (Cardan da Tração)

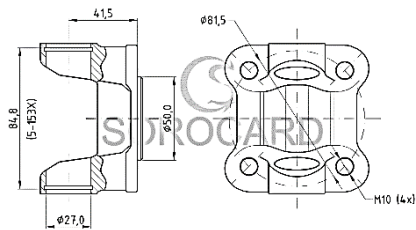

SG-19



Referência: 2-28-357
Original: -
Ford: JEEP RURAL 4X2 / 4X4
VW: KOMBI 1.600

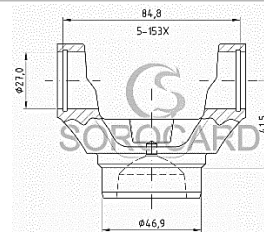

SG-28



Referência: 2-28-437
Original: -
Ford: F350 - FORD PICK UP
GM: AC 10/14 - AC14 (4CIL)
Iveco: IVECO DAILY 35.10
 CHASSI CABINE / FURGÃO

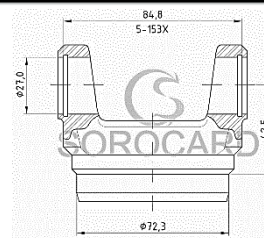

SG-48



Referência: -
Original: -
Kia: Kia Bongo (Adaptação da Cruzeta)

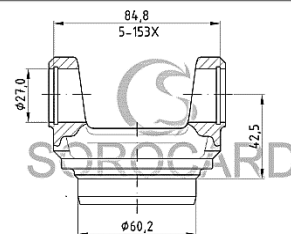

CRUZETA 5-153X

Cruzeta 5-153X

SG-55



Referência: 2-28-1757
Original: -
Nissan: FRONTIER
Toyota: HILUX PICK-UP

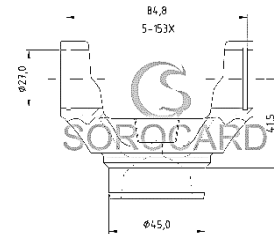

SG-56



Referência: -
Original: -
LAND ROVER: LAND ROVER

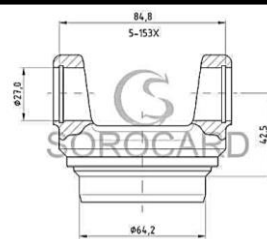

SL-07



Referência: 2-3-128KXS
Original: -
Ford: F350
GM: AC10 - AC14 - AC15 - ACD 10 - ACD14

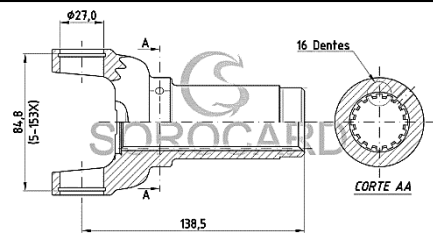

SL-37



Referência: 90-4-371-1
Original: 550-5527
Ford: F100
GM: C10 - C14
VW: KOMBI

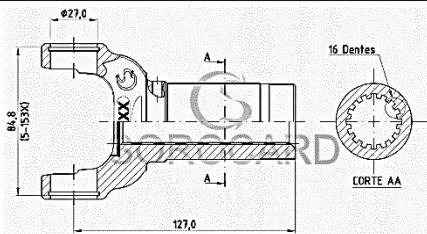

SL-45



Referência: 03-542XL
Original: -
Ford: TROLLER 2.8 4X4
Iveco: DAYLI 35.10 4X2

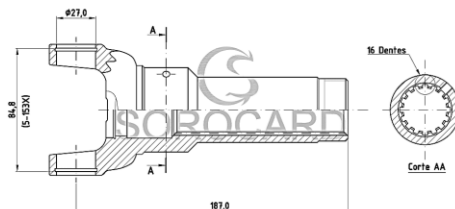

CRUZETA 5-153X

Cruzeta 5-153X

SL-47



Referência: -
Original: -
Ford: Kia Bongo (Adaptação da Cruzeta)

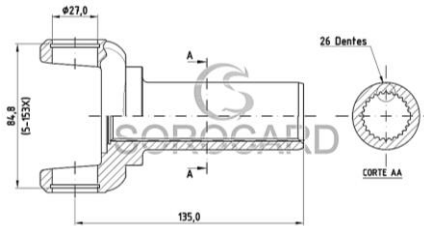

SL-54



Referência: -
Original: -
Mitsubishi: L200 Triton (Cardan da Tração) (Adaptação da Cruzeta)

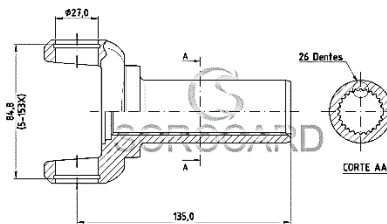

SP-07



Referência: 3-53-1371
Original: -
Ford: F 600 - F 11.000 - F 350 - F 4.000/4.3 Turbo - F 4000
GM: AC14 4 Cil - AC15 6 Cil - ACD10 4/6 Cil

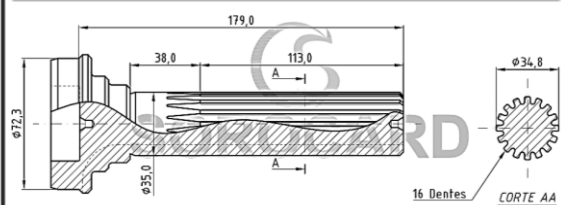

SP-37



Referência: 40-1408
Original: -
Ford: F75 - F100
GM: C10 - C14
VW: KOMBI

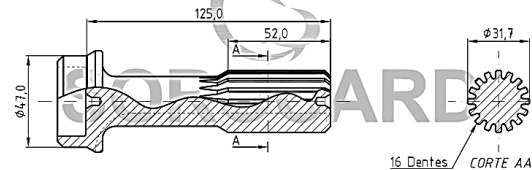

SP-45



Referência: 2-40-1701
Original: -
Ford: TROLLER 2.8 4X4
Iveco: DAYLI 35.10 4X2
Nissan: Frontier

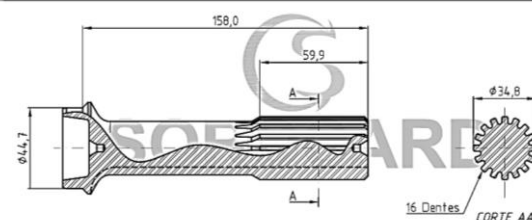

Cruzeta 5-153X

SP-46



Referência: -
Original: -
Ford: JEEP 4X2 / 4X4 - PICK UP 4X4 - RURAL 4X2 / 4X4
Fiat: PICK UP 4X4

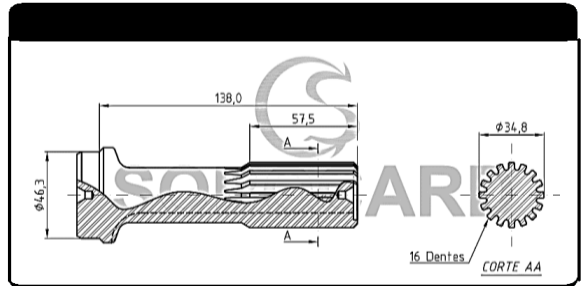

ST-65



Referência: -
Original: -
GM: S-10 - Adaptação da Homocinética (Cardan da Tração)

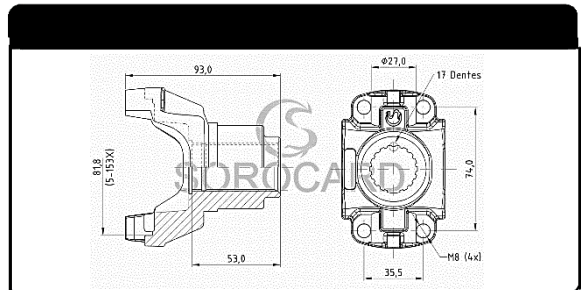

ST-79



Referência: -
Original: -
VW: Amarok (Adaptação do Cardan da Tração - saída do câmbio)

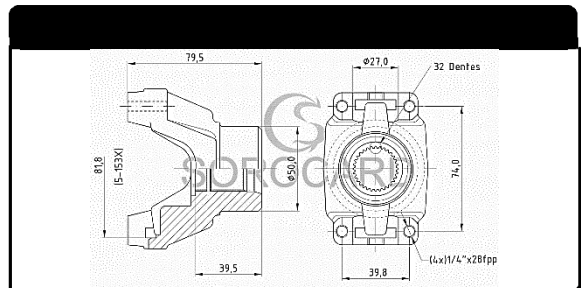

ST-80



Referência: -
Original: -
VW: Amarok (Adaptação do Cardan da Tração - saída do diferencial dianteiro)

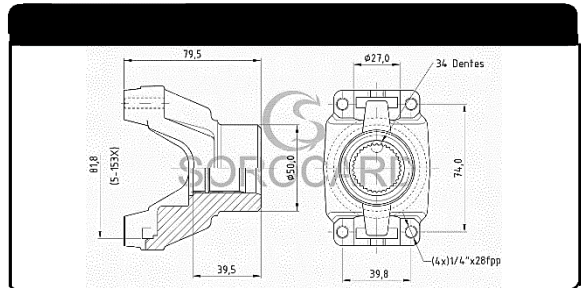

SCJ-07



Referência: -
Original: -
VW: Amarok (Adaptação do Cardan da Tração) - (Comprimento: 610 mm fechado)

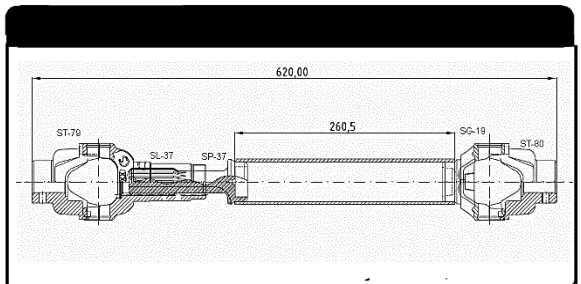

CRUZETA 5-153X

Cruzeta 5-153X

SCJ-09



Referência: -
Original: -
Ford: Ranger 4x4 (Cardan da Tração)
 (Adaptação da Homocinética)

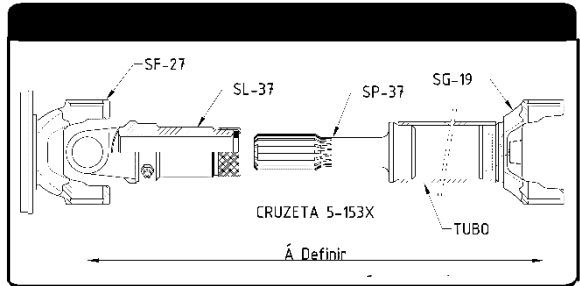

SCJ-10



Referência: -
Original: -
GM: S-10 (Adaptação do Cardan da Tração)
 (Comprimento Fechado: 805mm)

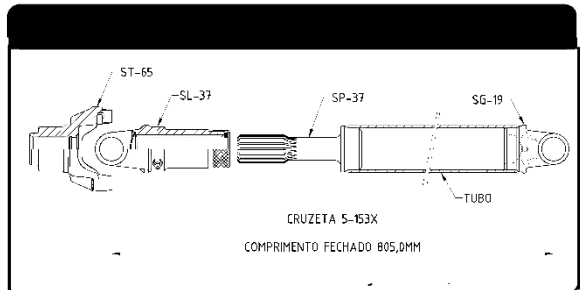

SCJ-11



Referência: -
Original: 3401 A994
Mitsubishi: L200 Triton
 (Tração Dianteira –
 Nacionalização da Cruzeta)
 (Comprimento: 655 mm
 fechado)

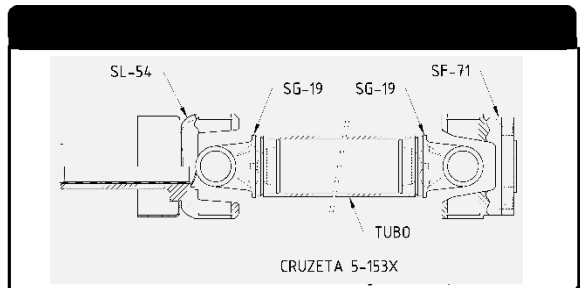

SCJ-13



Referência: -
Original: -
KIA: Bongo (Nacionalização da cruzeta)
 (Comprimento: 1.240 mm
 fechado)

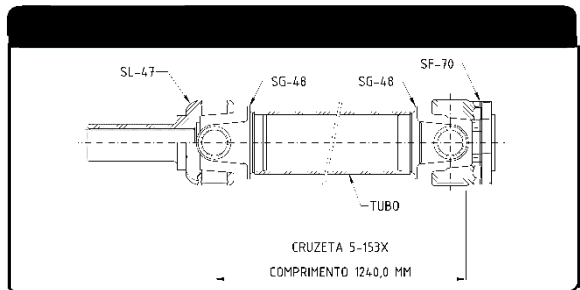

SCJ-14



Referência: -
Original: -
Nissan: FRONTIER
 (Cardan da Tração)
 (Comprimento Fechado: 790
 mm Flange a Flange)

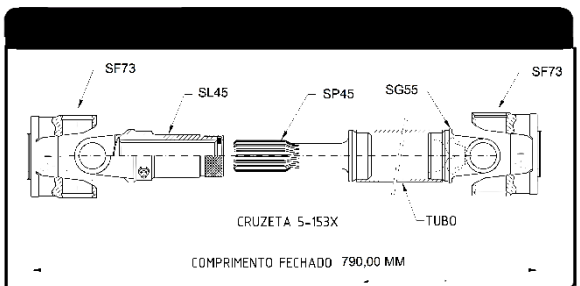

CRUZETA 5-153X

Cruzeta 5-310X

SF-35



Referência: 2-2-879
Original: -
GM: OPALA 4/6 CIL

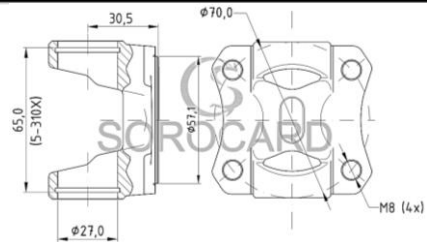

SG-02



Referência: 2-28-857
Original: -
GM: OPALA 4/6 CIL

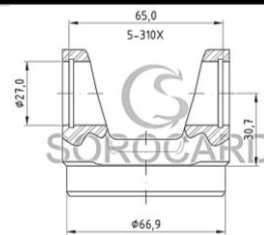

SG-29



Referência: 2-28-827
Original: -
Ford: BELINA PAMPA
GM: CHEVETTE

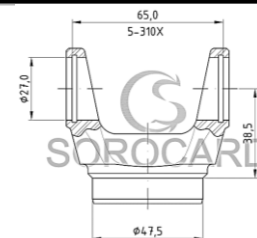

SG-53



Referência: 26-272
Original: -
GM: OPALA 6 / 4 CIL

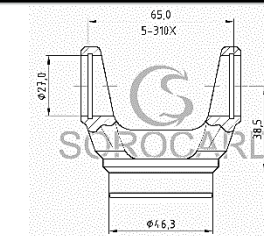

SL-36



Referência: -
Original: -
Ford: BELINA PAMPA
GM: OPALA 4/6 CIL (CARDAN)

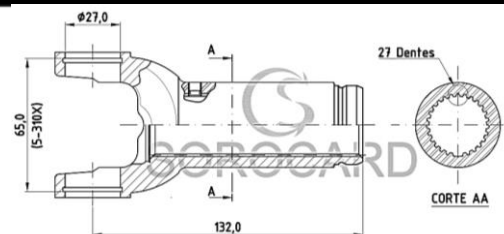

CRUZETA 5-310X

Cruzeta 5-310X

SL-38



Referência: 03-346X
Original: -
GM: OPALA 4/6 (CAMBIO 4 MARCHAS)

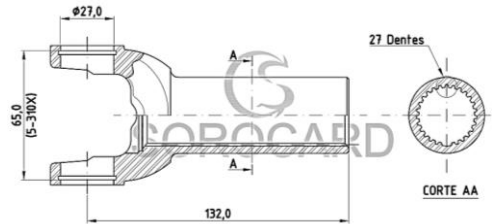

SP-36



Referência: 2-40-2271
Original: -
Ford: BELINA PAMPA
GM: OPALA 4/6 CIL. (CARDAN)

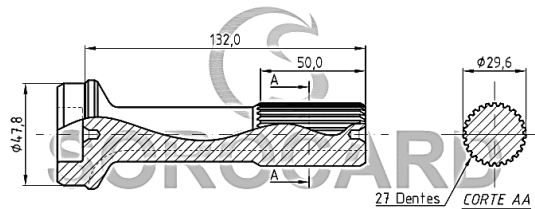

Libher

AUTO PARTS

- ✓ Cruzeta em aço SAE-5140
- ✓ Conjunto completo com travas
- ✓ Mais de 70 modelos a pronta entrega

Cruzeta 5-178X

SF-41



Referência: -
Original: -
Toyota: JEEP PICK-UP
 (todos)

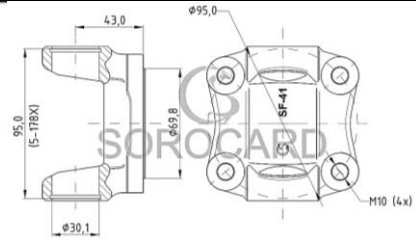

SF-74



Referência: -
Original: -
Ford: Ranger Turbo Diesel 3.2
 (2015 em diante)

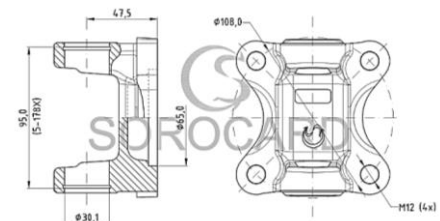

SF-75



Referência: -
Original: -
Toyota: Hilux 2016

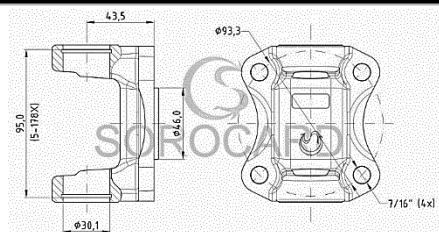

SG-31



Referência: -
Original: -
Toyota: BANDEIRANTE PICK UP (TODOS)

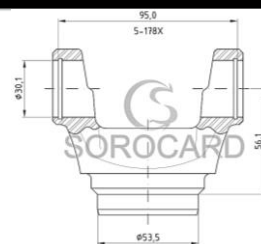

SG-32



Referência: 3-28-57
Original: -
Toyota: HILUX

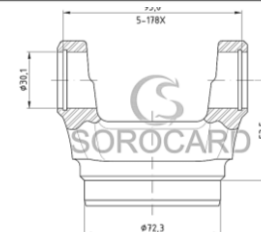

CRUZETA 5-178X

Cruzeta 5-178X

SL-25



Referência: -
Original: -
GM: C14 - 1414
Toyota: JEEP PICK-UP

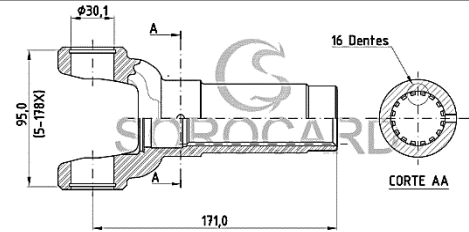

SL-51



Referência: -
Original: -
GM: S-10 - CARDAN PRINCIPAL (ESTRIA REFORÇADA)

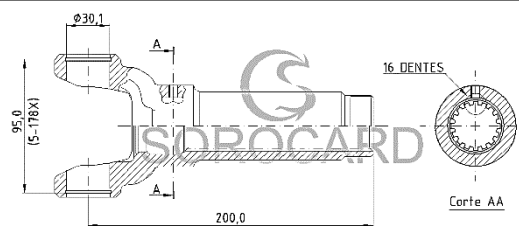

SP-25



Referência: -
Original: -
Toyota: JEEP PICK-UP (todos)

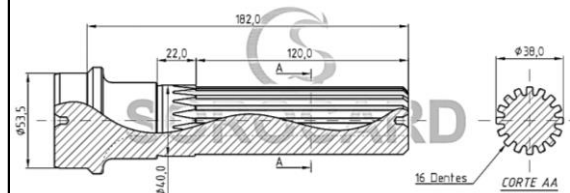

SP-51



Referência: -
Original: -
GM: S-10 - CARDAN PRINCIPAL (ESTRIA REFORÇADA)

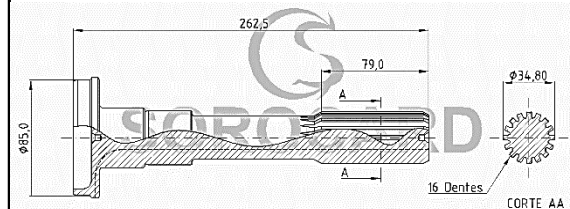

CRUZETA 5-178X

Cruzeta 5-160X

SF-16

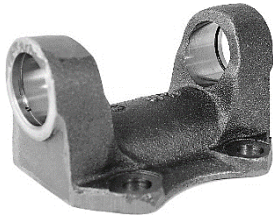

Referência: 3-2-159
Original: -
GM: C64 - C65 - CD 64/65/68
- D 64/65/74 (CARDAN D/T)

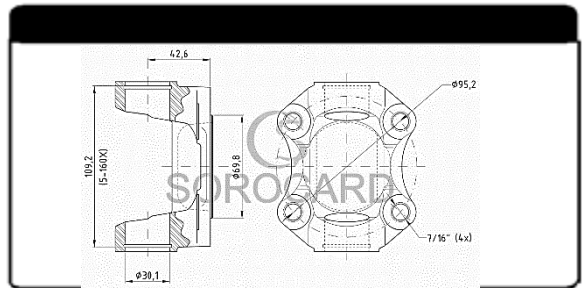

SF-20



Referência: -
Original: -
MB: SPRINTER 312/412
(ADAPTAÇÃO)

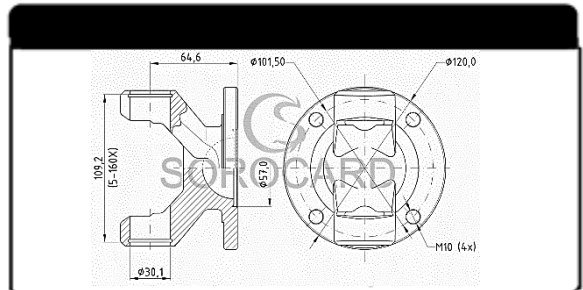

SF-38



Referência: 3-2-559
Original: -
Ford: F600 - F11000
GM: D75 - D79
Iveco: FIAT 70 - FIAT 80
VW: D400 - D900

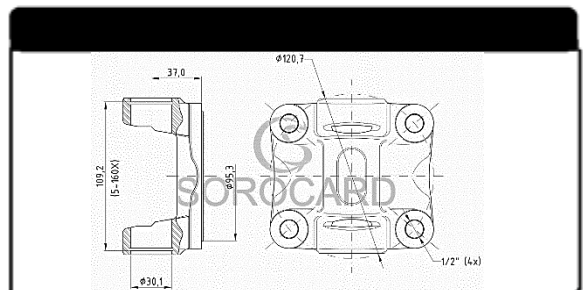

SF-52

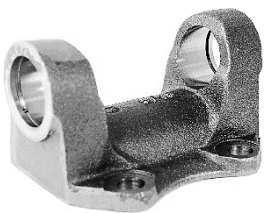

Referência: 3-2-1329
Original: -
Iveco: IVECO DAILY 35.12 /
49.10 / 49.12 - CHASSI /
CABINE / FURGÃO

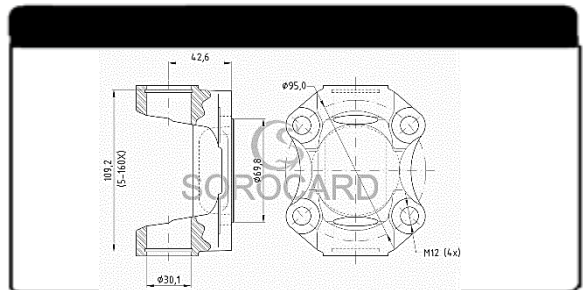

SF-61



Referência: -
Original: -
MB: Sprinter 311 / 415
(Câmbio)

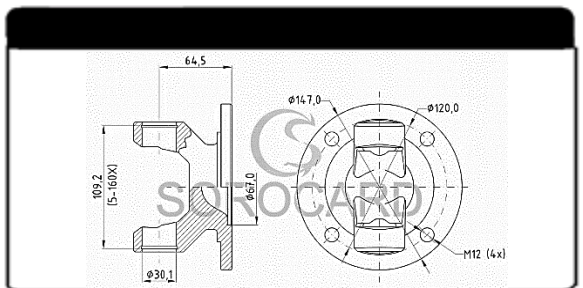

CRUZETA 5-160X

Cruzeta 5-160X

SF-62



Referência: -
Original: -
MB: Sprinter 311 / 415
 (Diferencial)

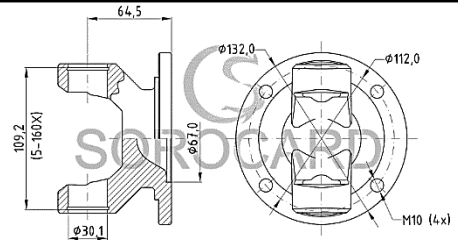

SG-23



Referência: 3-28-97
Original: -
Ford: F600 - F1000 - F4000 - F11000
GM: CD65/65/68 - D20 - BLAZER SILVERADO
Iveco: IVECO DAILY 6012 - 6013 - 70C16 - 7012 - 5912 MAX VAN

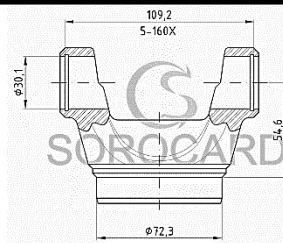

SG-24



Referência: 3-28-557
Original: -
Ford: F350 - F600 - F11000
MB: SPRINTER

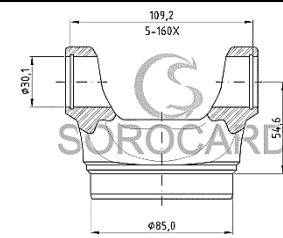

SG-52



Referência: -
Original: -
MB: SPRINTER 311 / 415

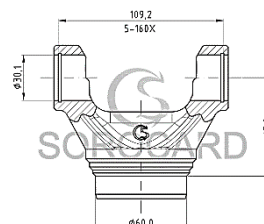

SG-57



Referência: -
Original: -
MB: SPRINTER

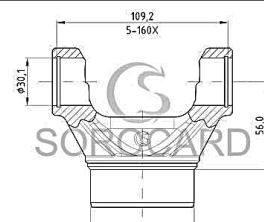

CRUZETA 5-160X

Cruzeta 5-160X

SL-08



Referência: 3-3-788KX
Original: -
Ford: F350 - F600 - F4.000 - F11.000

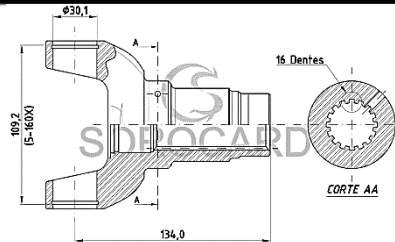

SL-09



Referência: 3-3-1481 KX
Original: -
GM: 6.100 - 6.150 - A/C/D 40 - C/D 64/65/68 - GRAND BLAZER - SILVERADO TURBO

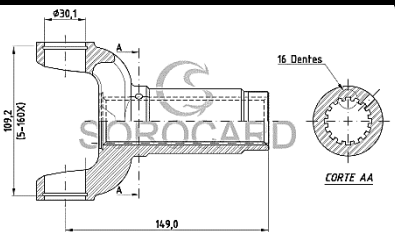

SL-23



Referência: 3-3-118 KX
Original: -
Ford: F1000 - TURBO
GM: D20 TURBO - BONANZA TURBO DIESEL

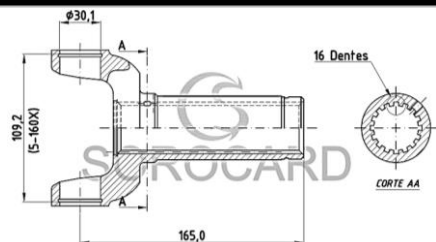

SL-44



Referência: 3-3-2041KX
Original: -
MB: SPRINTER

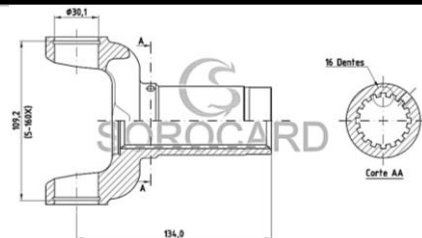

SL-52



Referência: -
Original: -
Ford: F-350 - Ranger - Dakota (Adaptação da Estria)

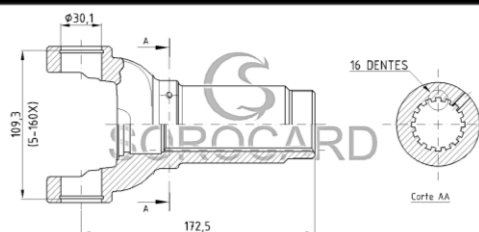

CRUZETA 5-160X

Cruzeta 5-160X

SP-08



Referência: 53-1433
Original: -
Ford: F 600 - F 11.000 - F 600
 Diesel/Gasolina

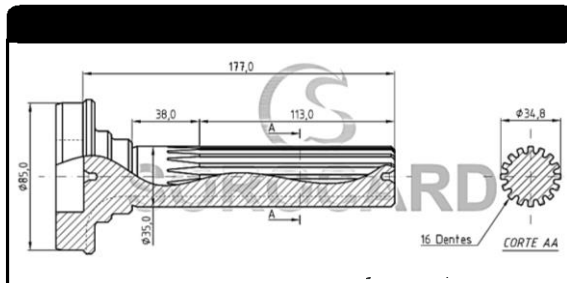

SP-09



Referência: 3-53-1361
Original: -
Ford: F600
GM: D20 TURBO - A/C/D 40 -
C/D 64/65/68 - 6.100 - 6.150 -
GRAND BLAZER -
SILVERADO TURBO

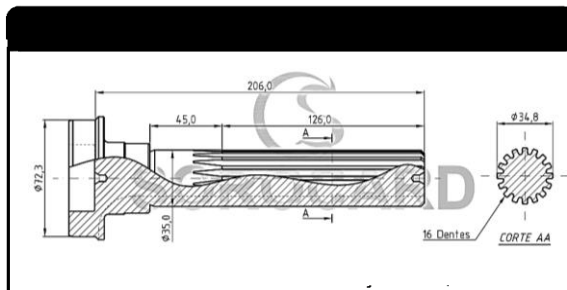

SP-23



Referência: 3-40-1901
Original: -
Ford: F1000
GM: D20 TURBO - BONANZA
TURBO DIESEL

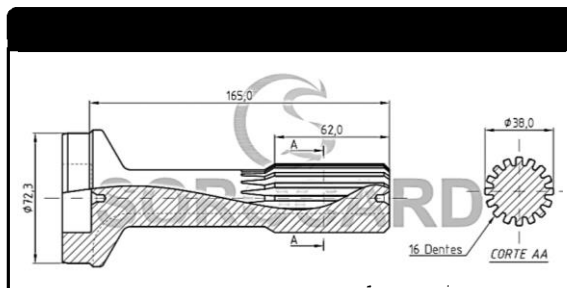

Você conhece o nosso
Catálogo Eletrônico ?



Conversões Completas

Fazemos as mais diversas conversões.
 Originais, Referências, Similares.
 O Mais completo catálogos de conversões !

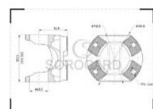

Dimensional Completo

Todos os itens do catálogo possuem dimensional completo abastecidos com os desenhos originais de cada peça, item por item.

Cruzeta 5-273X

SF-12



Referência: -
Original: -
Outros: BESTA - TOPIC
 (NACIONALIZAÇÃO DO
 CARDAN)

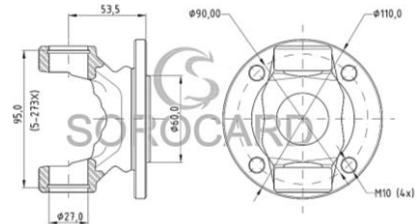

SF-48



Referência: 2-2-489
Original: -
GM: S-10

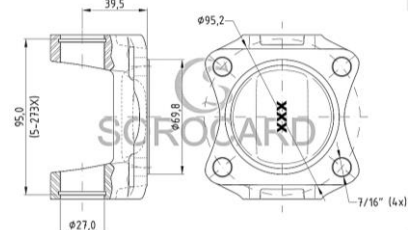

SF-60



Referência: -
Original: -
VW: Amarok (Adaptação da
 Cruzeta)

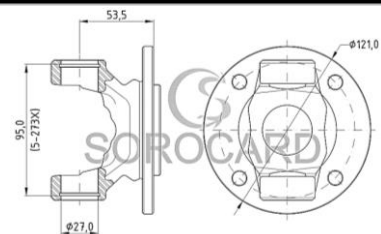

SF-65



Referência: -
Original: -
Toyota: Hilux - SW4 (4X2 /
 4X4) de 2005 até 2008

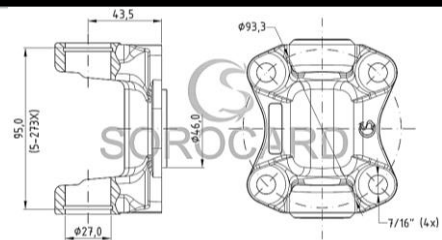

SF-66



Referência: -
Original: -
Ford: Ranger 3.0 4x2
 (Diferencial) - Ranger 3.0 4x4
 (Câmbio) - CARDAN DE
 ALUMÍNIO

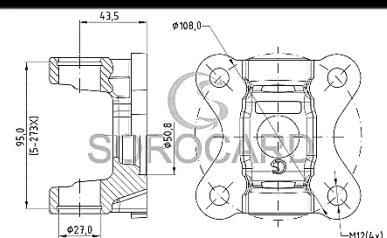

CRUZETA 5-273X

Cruzeta 5-273X

SL-05



Referência: 2-3-14-501KX

Original: -

Ford: F350 - F400 - F2000 - F4000

GM: AC20 - AC25 - D20 - D25 - BLAZER - S10 - SILVERADO

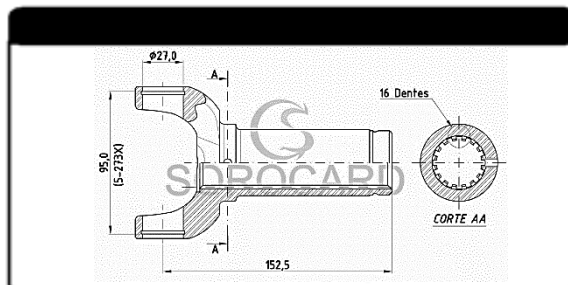

SL-43



Referência: 2-3-14371X

Original: -

GM: BLAZER - S10 4x2

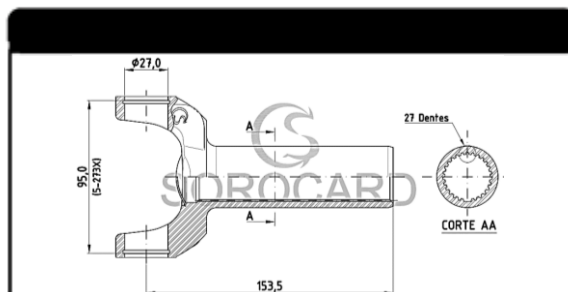

SL-49



Referência: -

Original: -

Toyota: Hilux / SW4 (4x4) - 2005 em diante (CARDAN PRINCIPAL) - (SPICER: 5001906 - ADAPTAÇÃO DA ESTRIA)

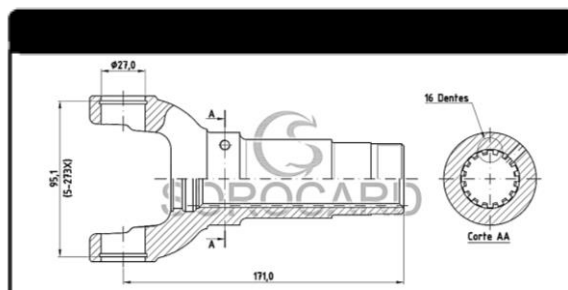

SP-05



Referência: 2-40-1521

Original: -

Ford: F 1000 Turbo - Pick up - TROLLER T4TDI / RF SPORT

GM: AC20 - AC24 - ACD10 - ACD14 - Bonanza - Bonanza Diesel - D20 - D24

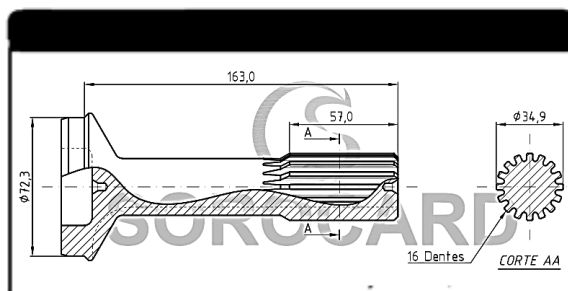

SP-05A



Referência: 2-40-1521

Original: -

Ford: F 1000 Turbo - Pick up - TROLLER T4TDI / RF SPORT

GM: AC20 - AC24 - ACD10 - ACD14 - Bonanza - Bonanza Diesel - D20 - D24

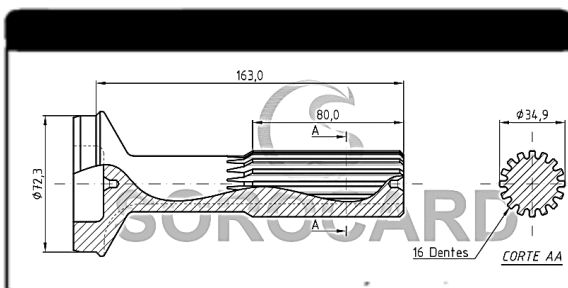

CRUZETA 5-273X

Cruzeta 5-273X

SP-10



Referência: 2-53-501

Original: -

Ford: F400 - F350 - F2000 - F4000(82/...)

GM: AC 20 - AC25 - C 64 - C65 - CD 64 - CD65 - D20/25/64/65/74/75 - Grand Blazer 6 Cil. - S10

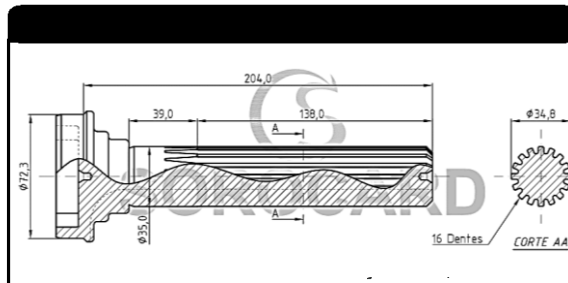

SP-49



Referência: -

Original: -

Toyota: Hilux / SW4 (4x4) - 2005 em diante (SPICER: 5001918 - ADAPTAÇÃO DA ESTRIA)

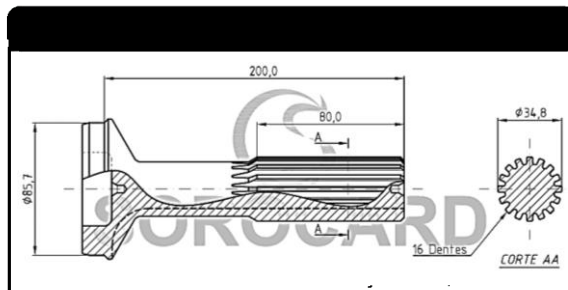

ST-06



Referência: -

Original: -

Ford: F4000 - F350 (CÂMBIO)

GM: D20 (CÂMBIO)

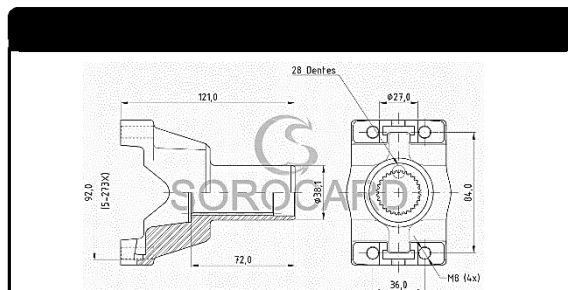

Por que ser um cliente da Sorocard ?



Terças e Quintas: Redespacho **grátis** para a região de **São Paulo**.

Quartas-feiras: entregas **grátis** para a região de **Campinas**.

Todos os dias: coletas de transportadoras na **Sorocard**.

Não Temos Faturamento Mínimo !

A partir do segundo pedido, você tem a liberdade total de fazer compras de qualquer valor, não importa a quantidade, enviamos para você !



Produtos à pronta entrega !

A Sorocard conta com um estoque que possui mais de 450 itens, sendo todos eles a pronta entrega ! Alinhado aos nossos prazos de entregas, temos a certeza que iremos te surpreender.

Sistema de gestão de qualidade !

A Sorocard faz parte do grupo de empresas nacionais que é certificada pela ISO 9001. Isso garante que nossos processos seguem padrões internacionais de qualidade e segurança. Produto 100% Nacional com qualidade garantida !



Entre em contato conosco, faça parte da Sorocard !

OUTROS

LC-178



Referência: 5-178X

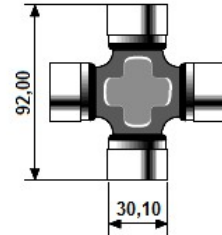

LC-160



Referência: 5-160X

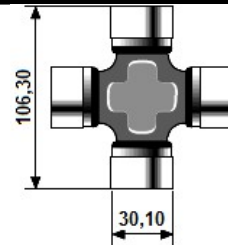

LC-273



Referência: 5-273X

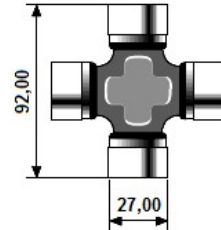



Curtiu ?

Então chama a gente !

Anote nossos canais de comunicação



(15) 3339-9300

(15) 9 7401-9554



SOROCARD-VENDAS1

@HOTMAIL.COM

VENDAS@SOROCARD

.COM.BR



FACEBOOK.COM

/SOROCARD

96*17916



WWW.SOROCARD

.COM.BR

Mais de **450** tipos
de peças diferentes
em estoque



Sorocard

O MELHOR TORQUE DE PONTA A PONTA